

2

1

*PLEASE NOTE HAT WE ARE MANUFACTURING THIS HEATER TO THE HIGH LIMIT DUE TO THE SMALLER LENGTH.
WE RECOMMEND 60 TO 70 WATTS PER SQUARE INCH (96WATTS).
THIS HEATER IS AT 88 WATTS PER SQUARE INCH (130WATTS)

**THIS HEATER MUST BE IMMERSSED IN WATER/WATER SOLUTION

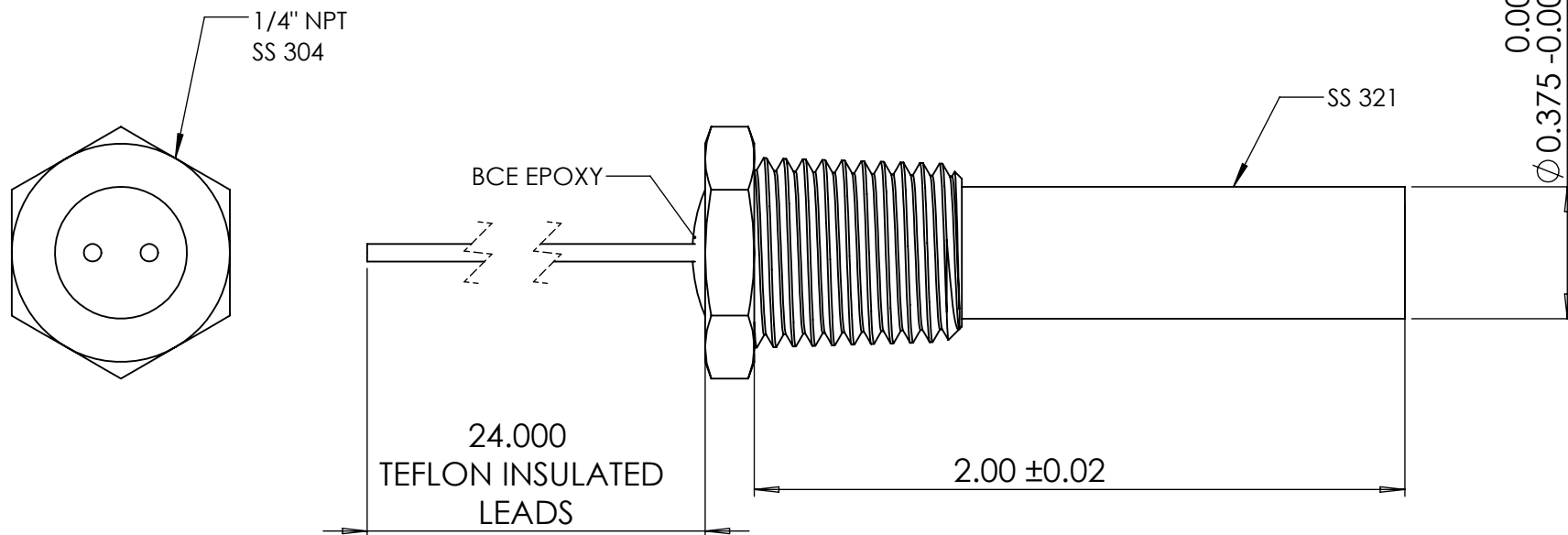
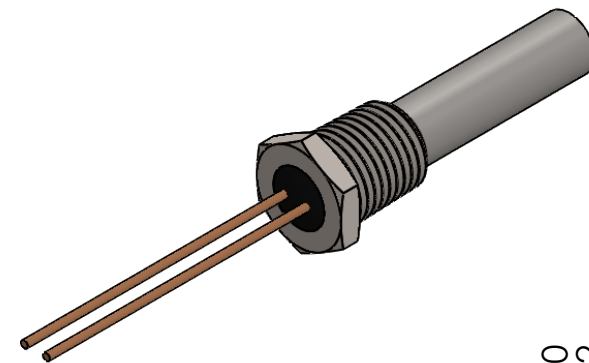

NOTES:

1. 120 VOLT, 130 WATT

The information given herein is based on data believed to be accurate, but BCE makes no expressed or implied warranties as to its accuracy and assumes no liability arising out of its use by others. This information does not constitute a license to use or infringe on any patents

PROPRIETARY AND CONFIDENTIAL

THE INFORMATION CONTAINED IN THIS DRAWING IS THE SOLE PROPERTY OF BELLOVE CO. ENGINEERS. ANY REPRODUCTION IN PART OR AS A WHOLE WITHOUT THE WRITTEN PERMISSION OF BELLOVE CO. ENGINEERS IS PROHIBITED.

UNLESS OTHERWISE SPECIFIED:

DIMENSIONS ARE IN INCHES
TOLERANCES:
FRACTIONAL ±
ANGULAR: MACH ± BEND ±
TWO PLACE DECIMAL ± .010
THREE PLACE DECIMAL ± .005

INTERPRET GEOMETRIC
TOLERANCING PER:

MATERIAL
SEE DWG

FINISH
N/A

DO NOT SCALE DRAWING

PART. NO.

BCE

TITLE:

IMMERSION HEATER

SIZE

A

DWG. NO.

BCE 10882

REV

0

SCALE: NTS

WEIGHT: N/A

SHEET 1 OF 1

2

1

B

B

A

A